

| | | | | |
|---------------------------------|------------------|-----------|---------|-----------------------------|
| Bodengruppe (Unterseite) | Spannung | Baugruppe | Ausgabe | gültig ab Seriennummer |
| Bottom (Lower elevation) | Voltage | Group | Edition | Application from Serial.No. |
| | 3 N AC 400V 50Hz | 10 | 10.1.1 | C22C93065001 |

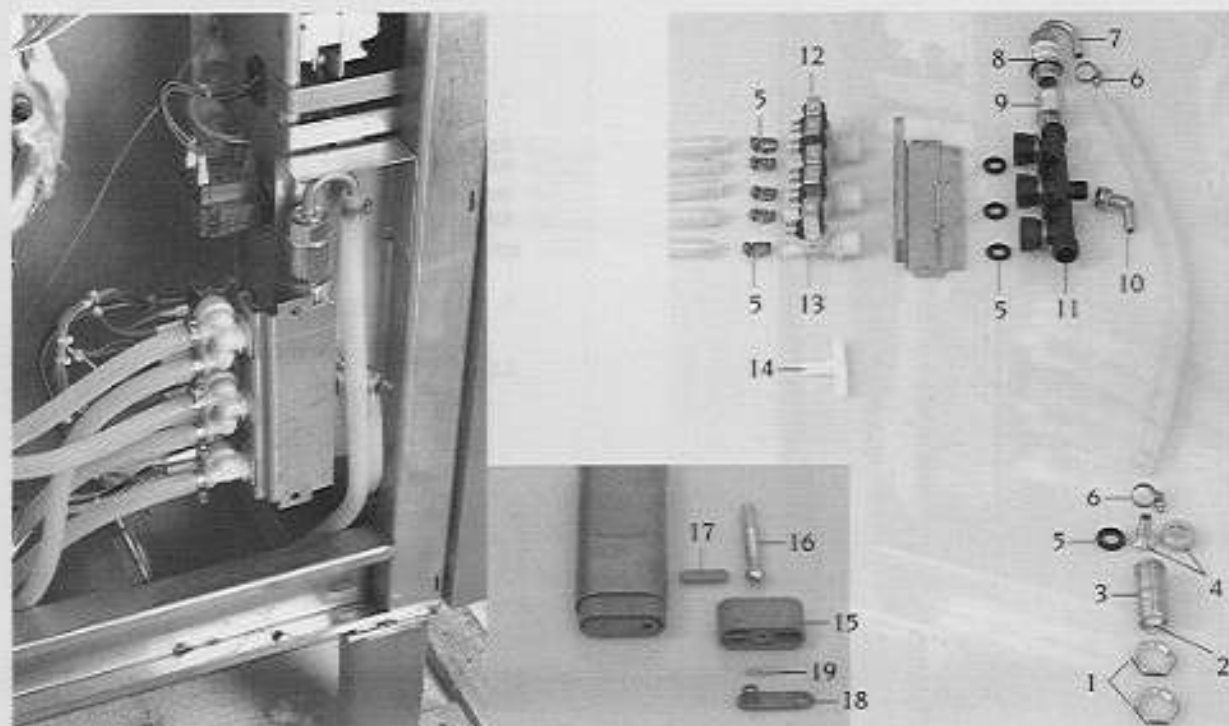

| Pos. | St. | Ersatz.Nr. | Bezeichnung | Description |
|------|------|--------------|--|--|
| Pos. | Pcs. | Sp. Part No. | | |
| - | - | 2067.0050 | Silikon Schlauch 1m | Silicone hose 1m |
| - | 4 | 8664.1017 | Gerätefuß kpl. | Foot adjustable cpl. |
| 1 | 2 | 2062.0313 | Kontermutter G 3/4 | Lock-nut G 3/4 |
| 2 | 1 | 1900.0202 | Wasserfilter grob | Water filter coarse |
| 3 | 1 | 1500.1582 | Gewindenippel G3/4" | Thread nipple G3/4" |
| 4 | 1 | 2062.0314 | Geradeverschraubung G 3/4 | Straight threaded joint G 3/4 |
| 5 | 4 | 5110.1024 | Dichtung für Verschraubung G 3/4" | Gasket for G3/4" threaded joint |
| 6 | 8 | 2066.0205 | Schlauchschnelle 12-18mm | Hose clamp 12-18mm |
| 7 | 1 | 1500.1571 | Rohranschluß | Tube connection |
| 8 | 1 | 2069.0102 | Armaturenkombination | Valve unit with non-return valve |
| 9 | 1 | 1500.1572 | Muffe G3/4" | Threaded sleeve G3/4" |
| 10 | 1 | 2062.0208 | Winkelverschraubung G1/2"x10" | Elbow screw point G1/2"x10" |
| - | 1 | 5012.0539 | Dichtung für Verschraubung G 1/2" | Gasket for G1/2" threaded joint |
| 11 | 1 | 8664.1007 | Wasserverteiler | Water distribution unit |
| 12 | 2 | 3002.0330 | Doppelmagnetventil kpl. 220-240V/50Hz | Double solenoid valve unit 220-240V/50Hz |
| 13 | 1 | 3002.0331 | Einfachmagnetventil kpl. 220-240V/50Hz | Single solenoid valve unit 220-240V/50Hz |
| 14 | 1 | 2062.0302 | T-Stück TS10 | T-piece TS 10 |
| - | 2 | 1106.0801 | Sechskant-Combi-Mutter M 6 | Hexagonal combination nut M6 |
| 15 | 4 | 2039.0104 | Fußunterteil | Lower part for foot adjustable |
| 16 | 4 | 2120.1037 | Spindel für Gerätefuß | Spindle for foot adjustable |
| - | 4 | 1805.1801 | Spannhülse A5x12 | Adapter sleeve A5x12 |
| 17 | 4 | 2039.0105 | Kunststoffabdeckung | Cover plate |
| 18 | 4 | 8664.1018 | Fußarretierung | Arrestment for foot adjustable |
| 19 | 4 | 1005.1906 | Zylinderstift A5x32 | Straight pin A5x32 |

| | | | | |
|--------------------------------|------------------|-----------|---------|-----------------------------|
| Bodengruppe (Oberseite) | Spannung | Baugruppe | Ausgabe | gültig ab Seriennummer |
| Bottom (Top elevation) | Voltage | Group | Edition | Application from Serial.No. |
| | 3 N AC 400V 50Hz | 9 | 9.1.1 | C22C93065001 |

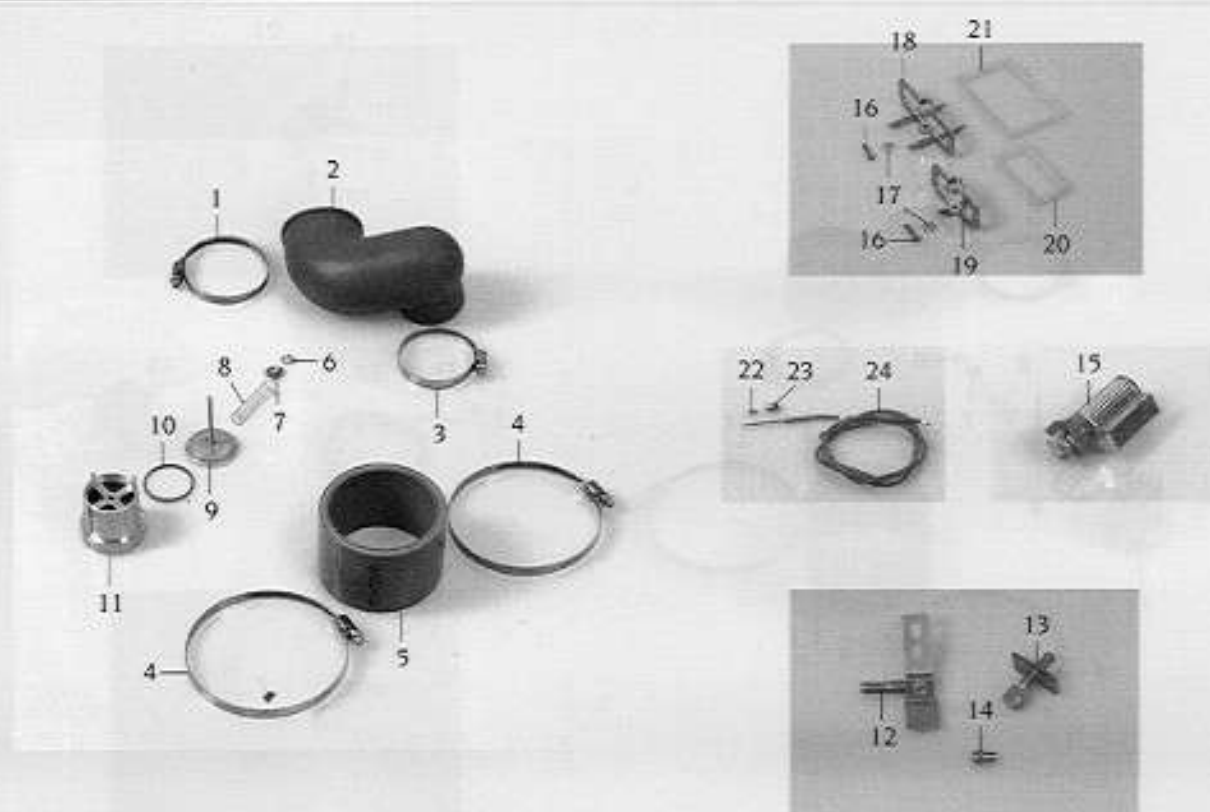

| Pos. | St. | Ersatz.Nr. | Bezeichnung | Description |
|------|------|--------------|---|--|
| Pos. | Pcs. | Sp. Part No. | | |
| - | - | 2067.0050 | Silikonschlauch 1m | Silicone hose 1m |
| 1 | 1 | 2066.0300 | Schlauchschnelle 50-70mm | Hose clamp 50-70mm |
| 2 | 1 | 5012.0570 | Haube f. Sicherheitsventil | Cap for safety valve |
| 3 | 1 | 2066.0504 | Schlauchschnelle 40-60mm | Hose clamp 40-60mm |
| 4 | 2 | 2066.0524 | Schlauchschnelle 90-110mm | Hose clamp 90-110mm |
| 5 | 1 | 2112.1016 | Dampfschlauch 80x7mm | Steam hose 80x7mm |
| 6 | 1 | 1107.0100 | Schnellbefestiger 4.0 mm | Quick fastener 4.0 mm |
| 7 | 1 | 1105.0122 | Sechskant-Combi-Mutter M 5 | Hexagonal combination nut M5 |
| 8 | 1 | 2064.1002 | Unterdruckfeder f. Sicherheitsventil | Vacuum/depression spring for safety valve |
| 9 | 1 | 2064.1001 | Unterdruckstempel f. Sicherheitsventil | Vacuum/depression ram for safety valve |
| 10 | 1 | 2064.1003 | Unterdruckdichtung f. Sicherheitsventil | Vacuum/depression gasket for safety valve |
| 11 | 1 | 2064.1000 | Überdruckgewicht f. Sicherheitsventil | Overpressure weight for safety valve |
| - | 1 | 2064.1004 | Überdruckgewichtdichtung f. Sicherheitsventil | Overpressure weight gasket for safety valve |
| 12 | 1 | 8666.1050 | Ablöschdüse Ablaufkasten | Quenching nozzle for outlet box |
| 13 | 5 | 8666.1046 | Ablöschdüse kpl. 3,9 l/min. | Quenching nozzle unit 3,9 l/min. |
| - | 5 | 5110.1013 | Dichtung Ablöschdüse | Gasket for quenching nozzle |
| 14 | 1 | 2035.0111 | Zungendüse für Beschwadung | Moistening nozzle |
| 15 | 1 | 3101.1004 | Querstromlüfter | Cooling fan |
| 16 | 2 | 1008.0751 | Sechskantschraube M5x25 | Hexagonal screw M 5x25 |
| 17 | 2 | 1315.0260 | Unterlegscheibe A5.3 | Washer A5.3 |
| 18 | 1 | 2940.1014 | Fixierung groß für Gerätedeckel | Large fixing for top cover |
| 19 | 1 | 2940.1016 | Fixierung klein für Gerätedeckel | Small fixing for top cover |
| 20 | 1 | 5110.1019 | Dichtung klein für Ablöschkanal/ Gerätedeckel | Small gasket for quenching channel/top cover |
| 21 | 1 | 5110.1018 | Dichtung groß für Ablöschkanal/ Gerätedeckel | Large gasket for quenching channel/top cover |
| 22 | 1 | 3014.0162 | Dichtkegel für Thermoelement | Sealing cone for thermo element |
| 23 | 1 | 3014.0163 | Stopfbuchsnippel für Thermoelement | Gasket sleeve with nipple |
| 24 | 1 | 3014.0161 | Mantelthermoelement | Sheath thermo element |

| | | | | |
|-----------|------------------|-----------|---------|-----------------------------|
| ClimaPlus | Spannung | Baugruppe | Ausgabe | gültig ab Seriennummer |
| ClimaPlus | Voltage | Group | Edition | Application from Serial.No. |
| | 3 N AC 400V 50Hz | 3 | 3.1.1 | C22C93065001 |

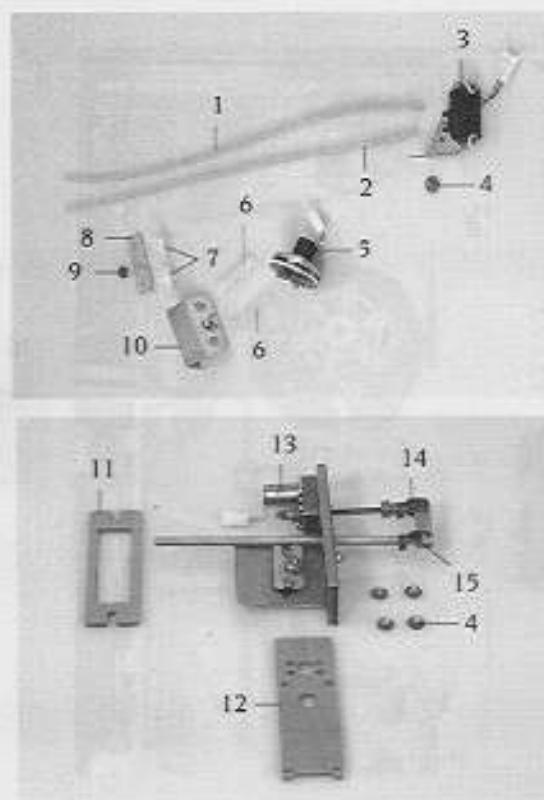
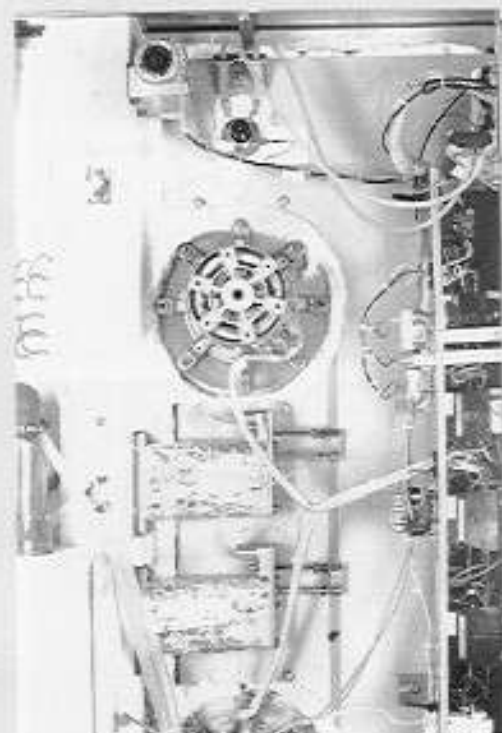

| Pos. | St. | Ersatz.Nr. | Bezeichnung | Description |
|------|------|--------------|---|---|
| Pos. | Pcs. | Sp. Part No. | | |
| - | 1 | 3040.2602 | Platine kpl. f. Feuchtmotor | PCB cpl. for sensor motor |
| - | 1 | 8680.1008 | Kondensatfilter vormontiert (Pos. 6-10) | Pre-fitted condenser filter (pos. 6-10) |
| 1 | 1 | 2112.1012 | Druckschlauch blau d 3x2,5x500mm | Pressure hose blue d 3x2,5x500mm |
| 2 | 1 | 2112.1013 | Druckschlauch rot d 3x2,5x500mm | Pressure hose red d 3x2,5x500mm |
| 3 | 1 | 8680.1018 | Drucksensor kpl. 164PC | Pressure sensor unit 164PC |
| 4 | 9 | 1105.0122 | Sechskant-Combi-Mutter M 5 | Hexagonal combination nut M5 |
| 5 | 1 | 8680.1006 | Motor f. Feuchtmessung kpl. | Sensor motor |
| 6 | 2 | 2112.1014 | Druckschlauch 8x2x80 | Pressure hose 8x2x80 |
| - | 2 | 2112.1015 | Druckschlauch 5x1,5x10 | Pressure hose 5x1,5x10 |
| 7 | 2 | 1900.0201 | Kondensatfilter | Condensation filter |
| 8 | 1 | 2760.1067 | Filterhalter oben | Holder top for condensation filter |
| 9 | 1 | 1106.0801 | Sechskant-Combi-Mutter M6 | Hexagonal combination nut M6 |
| 10 | 1 | 8680.1016 | Filterhalter unten | Holder below condensation filter |
| 11 | 2 | 5110.1032 | Dichtung Ablöschkanal Stellschieber | Gasket for quenching channel set slider |
| 12 | 2 | 5110.1025 | Dichtung Verschlußflansch | Gasket for closure flange |
| 13 | 2 | 3101.1001 | Stellmotor f. Schieber | Servo motor for slider |
| 14 | 2 | 2016.0402 | Federklappbolzen 6x12mm | Cap bolt with locking spring 6x12 mm |
| 15 | 2 | 2016.0403 | Federklappbolzen 4x16mm | Cap bolt with locking spring 4x16 mm |
| 16 | 1 | 3014.0162 | Dichtkegel für Thermoelement | Sealing cone for thermo element |
| 17 | 1 | 3014.0163 | Stopfbuchsnippel für Thermoelement | Gasket sleeve with nipple |
| 18 | 1 | 3014.0161 | Mantelthermoelement | Sheath thermo element |

| | | | | |
|--------------------------------------|--|--------------------------------|------------------------------------|--|
| Bedienblende Control Panel | Spannung Voltage 3 N AC 400V 50Hz | Baugruppe Group 1 | Ausgabe Edition 1.1.1 | gültig ab Seriennummer Application from Serial.No. C22C93065001 |
|--------------------------------------|--|--------------------------------|------------------------------------|--|

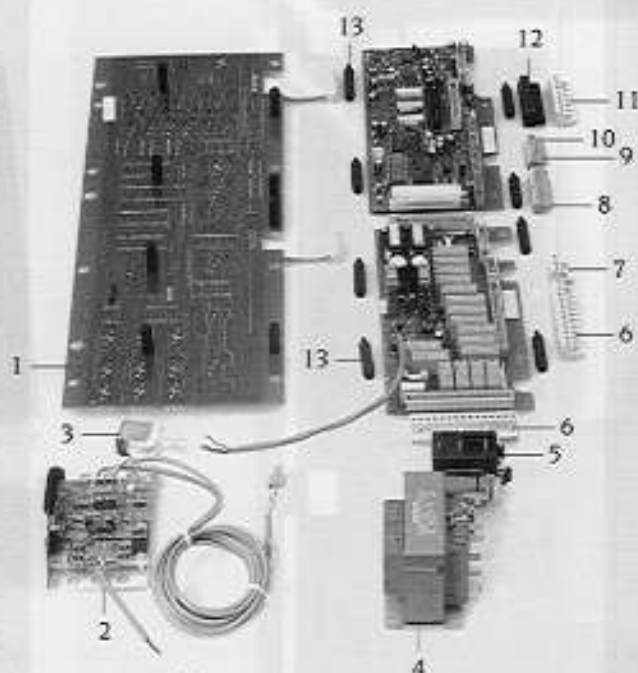
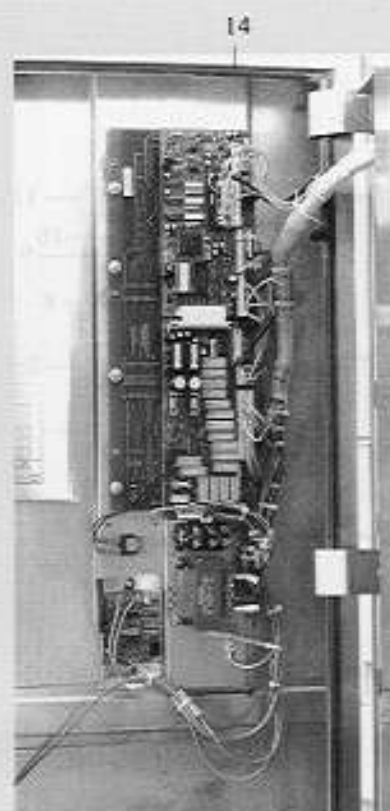

| Pos. | St. | Ersatz.Nr. | Bezeichnung | Description |
|------|------|--------------|----------------------------------|---------------------------------|
| Pos. | Pcs. | Sp. Part No. | | |
| - | 1 | 8461.5001 | Bedienblende kpl. | Control panel |
| 1 | 1 | 3040.2040 | Regel- und Steuerelektronik kpl. | PCB complete |
| - | 9 | 2039.0326 | Silikonfeder | Silicone spacer |
| 2 | 1 | 3040.2602 | Platine Für Feuchtmotor | PCB for sensor motor |
| 3 | 1 | 3006.0103 | Alarmsummer | Alarm buzzer |
| 4 | 1 | 3037.0203 | Steuertrafo 35VA | Transformer 35VA |
| 5 | 1 | 3028.0601 | Kleinschütz E 3250, 24V | Mini contactor E 3250, 24V |
| 6 | 2 | 3040.0230 | Steckerleiste BL 15 | Multipoint connector BL15 |
| 7 | 1 | 3040.0194 | Steckerleiste BL 4 | Multipoint connector BL4 |
| 8 | 1 | 3040.0227 | Steckerleiste BL 12 | Multipoint connector BL12 |
| 9 | 1 | 3040.0228 | Steckerleiste BL 9 | Multipoint connector BL9 |
| 10 | 1 | 3040.0229 | Steckerleiste BL 3 | Multipoint connector BL3 |
| 11 | 1 | 3040.0232 | Steckerleiste grau BL 10 | Multipoint connector grey BL10 |
| 12 | 1 | 3040.0231 | Steckerleiste schwarz BL 10 | Multipoint connector black BL10 |
| 13 | 16 | 1403.0169 | Abstandsbolzen M4x25 | Spacing bolt M4x25 |
| - | 1 | 3016.1408 | Türkontaktschalter | Door contact switch |
| 14 | 1 | 5105.1014 | Dichtungsrahmen f. Bedienblende | Gasket frame for panel |

| | | | | |
|------------------|------------------|------------------|----------------|------------------------------------|
| Gerätetür | Spannung | Baugruppe | Ausgabe | gültig ab Seriennummer |
| Door | Voltage | Group | Edition | Application from Serial.No. |
| | 3 N AC 400V 50Hz | 8 | 8.1.1 | C22C93065001 |

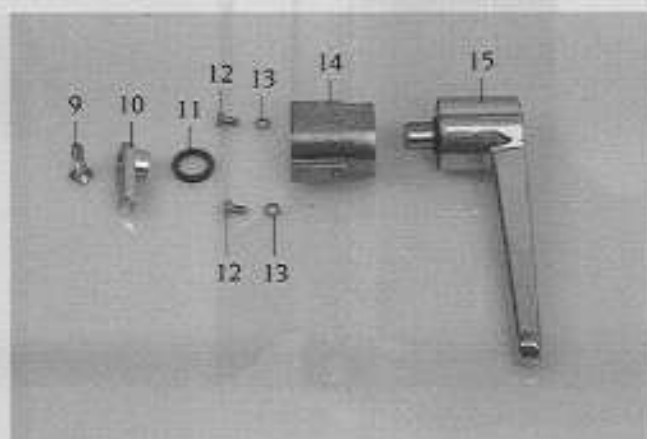
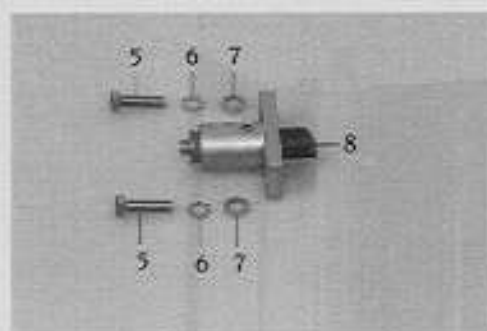
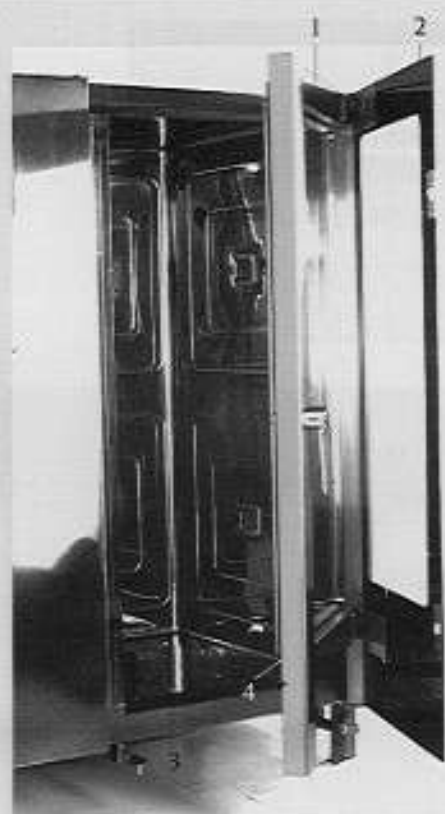

| Pos. | St. | Ersatz.Nr. | Bezeichnung | Description |
|------|------|--------------|---------------------------------|---------------------------------------|
| Pos. | Pcs. | Sp. Part No. | | |
| - | 1 | 8470.5003 | Gerätetür kpl. | Door cpl. |
| 1 | 1 | 5200.1004 | Glasscheibe innen | Internal glass panel |
| - | 1 | 5105.1006 | Dichtungsrahmen für Glasscheibe | Gasket frame for internal glass panel |
| 2 | 1 | 8474.1031 | Glastür außen kpl. | External glass-door unit |
| 3 | 1 | 5105.1010 | Dichtungsprofil HGW/ Garraum | Gasket profile HGW/ interior cabinet |
| 4 | 1 | 5105.1008 | Dichtungsrahmen Tür/ Garraum | Gasket frame door/ interior cabinet |
| 5 | 2 | 1008.0761 | Sechskantschraube M8x25 | Hex screw M8x25 |
| 6 | 2 | 1206.0120 | Zahnscheibe A6,4 | Toothed lock washer A6,4 |
| 7 | 2 | 1308.0160 | Unterlegscheibe A8,4 | Washer A8,4 |
| 8 | 1 | 8514.1038 | Fangkloben kpl. | Door catch cpl. |
| 9 | 1 | 1008.1960 | Senkschraube M8x30 | Countersunk screw M8x30 |
| - | 1 | 2039.0309 | Abdeck- Kappe | Silicone cap |
| 10 | 1 | 2940.1004 | Riegel | Door bolt |
| 11 | 1 | 5110.1015 | Dichtungsring | Sealing washer |
| 12 | 2 | 1006.0760 | Sechskantschraube M6x16 | Hex screw M6x16 |
| 13 | 2 | 1306.0120 | Unterlegscheibe A6,4 | Washer A6,4 |
| 14 | 1 | 8474.1019 | Verschluss kpl. | Lock unit |
| 15 | 1 | 2016.1501 | Türhebel | Door handle |

| | | | | |
|---|---------------------|--------------------|--------------------|---|
| Elektromontageplatte Electrical Installation | Spannung Voltage | Baugruppe Group | Ausgabe Edition | gültig ab Seriennummer Application from Serial.No. |
| | 3 N AC 400V 50Hz | 2 | 2.2.1 | C22C93065001 |

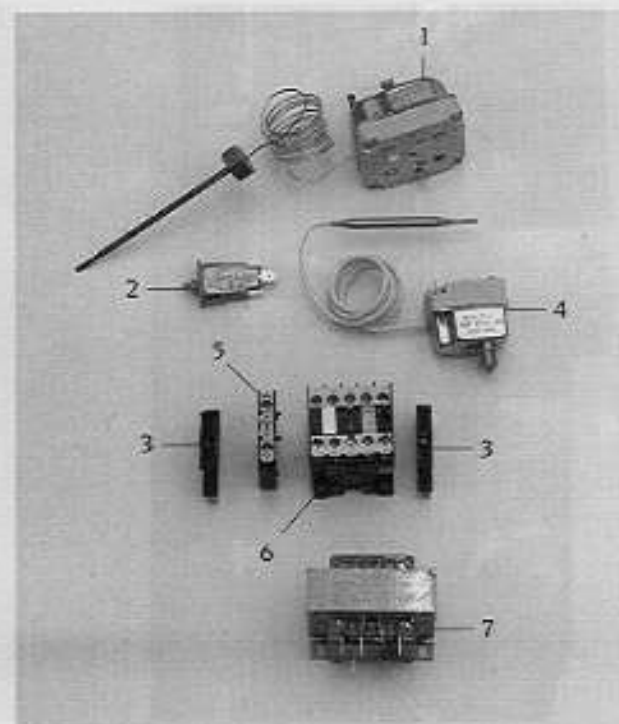
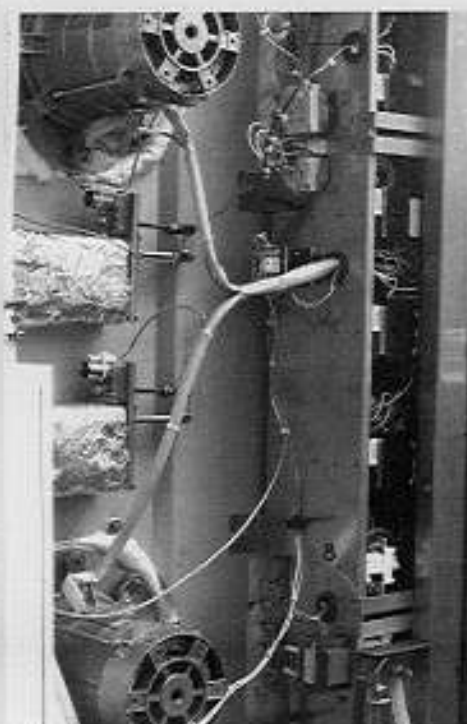

| Pos. | St. | Ersatz.Nr. | Bezeichnung | Description |
|------|------|--------------|--------------------------------------|--------------------------------------|
| Pos. | Pcs. | Sp. Part No. | | |
| 1 | 1 | 3014.0322 | Sicherheitstemperaturbegrenzer 360°C | Bi-limit safety thermostat 360°C |
| 2 | 1 | 3014.0400 | Überstromauslöser einpolig | Current limiter for motor protection |
| 3 | 2 | 4001.1203 | Endklammer für Trageschiene | End terminal for supporting rail |
| 4 | 1 | 3014.0300 | Trockengehschutz 125°C | Dry up protector 125°C |
| 5 | 1 | 3028.0158 | Hilfskontaktschalter HS 05.01 | Auxiliary contact switch HS 05.01 |
| 6 | 1 | 3028.0504 | Schütz LS 05.01 230V 50/60Hz | Contacteur LS 05.01 230V 50/60Hz |
| 7 | 1 | 3037.0204 | Halogentrafo | Halogen transformer |
| 8 | 3 | 2022.0105 | Durchführungsstülpe d 26mm | Lead-in grommet d 26mm |

| | | | | |
|---|-----------------------------------|----------------------------------|----------------------------------|---|
| Elektromontageplatte Electrical Installation | Spannung Voltage | Baugruppe Group | Ausgabe Edition | gültig ab Seriennummer Application from Serial.No. |
| | 3 N AC 400V 50Hz | 2 | 2.1.1 | C22C93065001 |

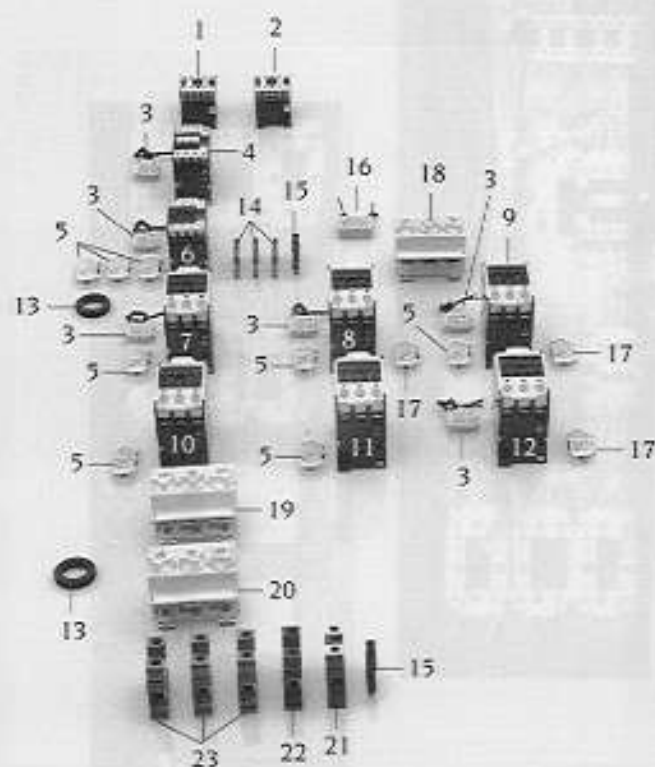
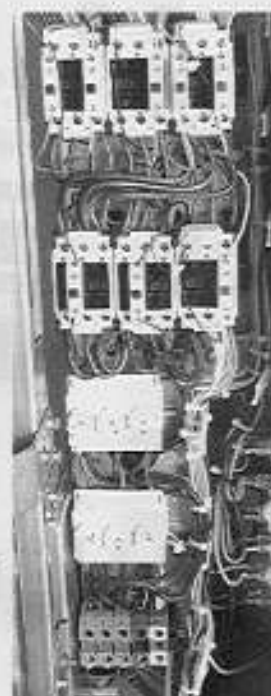

| Pos. | St. | Ersatz-Nr. | Bezeichnung | Description |
|------|------|--------------|---|---|
| Pos. | Pcs. | Sp. Part No. | | |
| 1 | 1 | 3028.0504 | Schütz LS 05.01 230V 50/60Hz | Contacteur LS 05.01 230V 50/60Hz |
| 2 | 1 | 3028.0504 | Schütz LS 05.01 230V 50/60Hz | Contacteur LS 05.01 230V 50/60Hz |
| 3 | 6 | 3035.0515 | RC-Glied | RC-Link |
| 4 | 1 | 3028.0507 | Schütz LS 04.01 220-240V 50/60Hz | Contacteur LS 04.01 220-240V 50/60Hz |
| 5 | 8 | 3028.0153 | Hilfskontaktschalter HS 17.10 | Auxiliary contact switch HS 17.10 |
| 6 | 1 | 3028.0507 | Schütz LS 04.01 220-240V 50/60Hz | Contacteur LS 04.01 220-240V 50/60Hz |
| 7 | 1 | 3028.0512 | Schütz LS 37.00 220-240V 50/60Hz | Contacteur LS 37.00 220-240V 50/60Hz |
| 8 | 1 | 3028.0512 | Schütz LS 37.00 220-240V 50/60Hz | Contacteur LS 37.00 220-240V 50/60Hz |
| 9 | 1 | 3028.0512 | Schütz LS 37.00 220-240V 50/60Hz | Contacteur LS 37.00 220-240V 50/60Hz |
| 10 | 1 | 3028.0512 | Schütz LS 37.00 220-240V 50/60Hz | Contacteur LS 37.00 220-240V 50/60Hz |
| 11 | 1 | 3028.0512 | Schütz LS 37.00 220-240V 50/60Hz | Contacteur LS 37.00 220-240V 50/60Hz |
| 12 | 1 | 3028.0512 | Schütz LS 37.00 220-240V 50/60Hz | Contacteur LS 37.00 220-240V 50/60Hz |
| 13 | 2 | 2022.0105 | Durchführungsstelle d 26mm | Lead-in grommet d 26 mm |
| 14 | 3 | 4001.1216 | Reihenklemme 4mm ² grau | Terminal 4mm ² grey |
| 15 | 2 | 4001.1203 | Endklammer für Tragschiene | End terminal for supporting rail |
| 16 | 1 | 3102.1000 | RC-Glied | RC-Link |
| 17 | 3 | 3028.0156 | Hilfskontaktschalter HS 17.01 | Auxiliary contact switch HS 17.01 |
| 18 | 3 | 3019.0401 | Sicherung Neozed 16A | Fuse neozed 16A |
| - | 3 | 4001.1238 | Paßeinsatz 16A | Insert adapter 16A |
| 19 | 3 | 3019.0404 | Sicherung Neozed 50A | Fuse neozed 50A |
| 20 | 3 | 3019.0404 | Sicherung Neozed 50A | Fuse neozed 50A |
| - | 6 | 4001.1241 | Paßeinsatz 50A | Insert adapter 50A |
| - | 3 | 4001.1234 | Einbausicherungssockel | Neozed fuse holder |
| - | 9 | 4001.1225 | Schraubkappe | Neozed screw cap |
| 21 | 1 | 4001.1233 | Erdungsreihenklemme 35mm ² gelb/grün | Earth terminal 35mm ² yellow/green |
| 22 | 1 | 4001.1252 | Reihenklemme 35mm ² blau | Terminal 35mm ² blue |
| 23 | 3 | 4001.1206 | Reihenklemme 35mm ² grau | Terminal 35mm ² grey |

| | | | | |
|---------------------------|---------------------|--------------------|--------------------|---|
| Handbrause Hand Shower | Spannung Voltage | Baugruppe Group | Ausgabe Edition | gültig ab Seriennummer Application from Serial.No. |
| | 3 N AC 400V 50Hz | 11 | 11.1.1 | C22C93065001 |

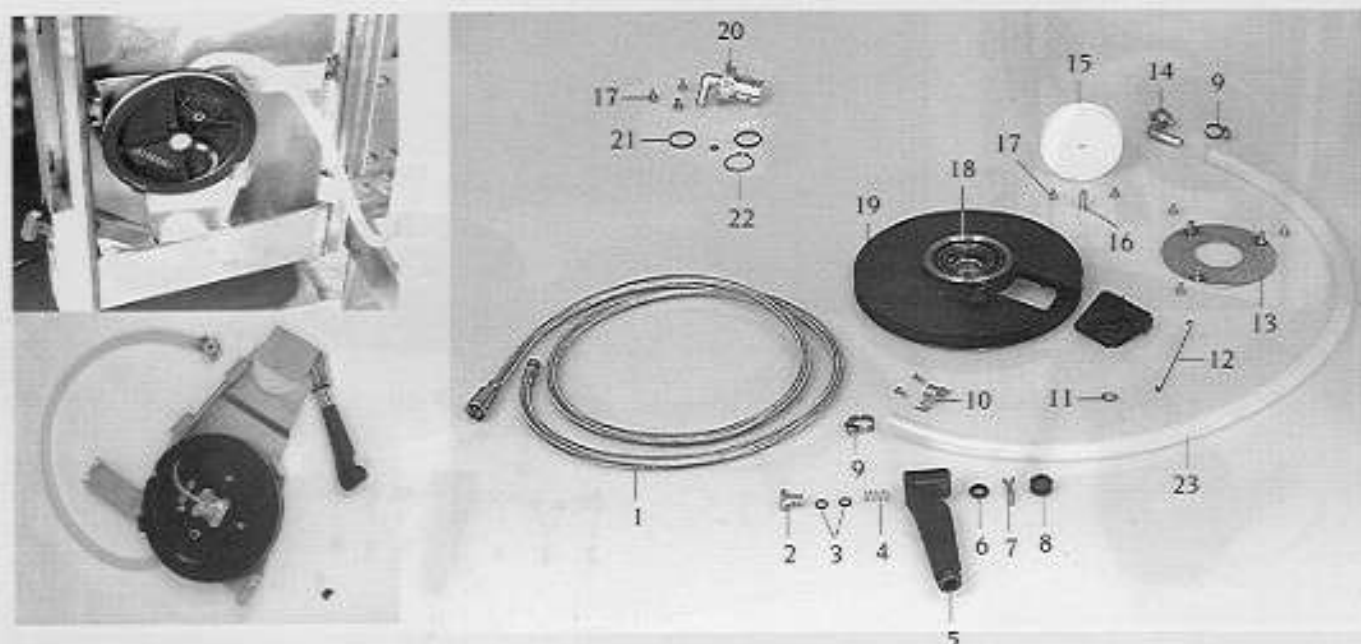

| Pos. Pos. | St. Pcs. | Ersatz.Nr. Sp. Part No. | Bezeichnung | Description |
|--------------|-------------|----------------------------|------------------------------------|--|
| - | - | 8655.3003 | Schlauchroller kpl. | Hand shower roll guide |
| 1 | 1 | 2067.0607 | Brauseschlauch 1500 mm | Shower hose 1500 mm |
| - | 2 | 2060.0228 | O-Ring | O-ring |
| 2 | 1 | 2060.1001 | Druckknopf für Handbrause | Push-button for hand shower |
| 3 | 2 | 5012.0559 | O-Ring f. Schlauchbrause d 7x2,5mm | O-ring d 7x2,5mm |
| 4 | 1 | 2001.0110 | Druckfeder f. Schlauchbrause | Compression spring |
| 5 | 1 | 2060.1000 | Handbrause kpl. (inkl.Pos 2-8) | Hand shower (incl.Pos 4-9) |
| 6 | 1 | 5012.0558 | O-Ring f. Schlauchbrause d 8x5mm | O-ring d 8x5mm |
| 7 | 1 | 2060.1003 | Steilkegelstift Handbrause | Steep taper pin for hand shower |
| 8 | 1 | 2060.1002 | Düse f. Handbrause | Jet for hand shower |
| 9 | 1 | 2066.0205 | Schlauchselle 12-18mm | Hose clamp 12-18mm |
| 10 | 1 | 2760.1159 | Befestigungsschelle | Hose clamp |
| - | 2 | 1003.0231 | Kerbschraube 3,9x13 mm | Slotted screw 3.9 x 13 mm |
| 11 | 1 | 2001.0203 | Federmutter d 8mm | Spring nut d 8 mm |
| 12 | 1 | 2001.0202 | Bügel Feder f. Schlauchroller | Return spring for hose roll guide |
| 13 | 1 | 8655.2005 | Sicherungsscheibe | Locking plate |
| 14 | 1 | 2062.0208 | Winkelverschraubung G1/2"x10 | Elbow screw point G1/2"x10 |
| - | 1 | 5012.0539 | Dichtung für Verschraubung G 1/2" | Gasket for G1/2" threaded joint |
| 15 | 1 | 2060.0112 | Schlauchrolle | Roll guide |
| 16 | 1 | 2060.0115 | Achse für Schlauchrolle | Axle for roll guide |
| 17 | 10 | 1005.2000 | Sperrzahnschraube M5x8 | Interlocking tooth screw M5x8 |
| 18 | 1 | 2001.0201 | Spiralfeder f. Schlauchroller | Spiral coiled spring for hose roll guide |
| 19 | 1 | 2060.0150 | Schlauchrad für Handbrause | Retractable wheel for hand shower |
| 20 | 1 | 2060.0157 | Achse f. Schlauchroller | Axle for hose roll |
| 21 | 1 | 8000.0081 | Satz O-Ringe | Set O-ring |
| 22 | 1 | 1250.0103 | Sicherungsring 28mm | Snap ring 28mm |
| 23 | 1 | 2067.0159 | Silikonschlauch 900mm | Silicone hose 900mm |

Heißluftheizung
Hot Air Heating

Spannung
Voltage
3 N AC 400V 50Hz

Baugruppe
Group
5

Ausgabe
Edition
5.1.1

gültig ab Seriennummer
Application from Serial.No.
C22C93065001

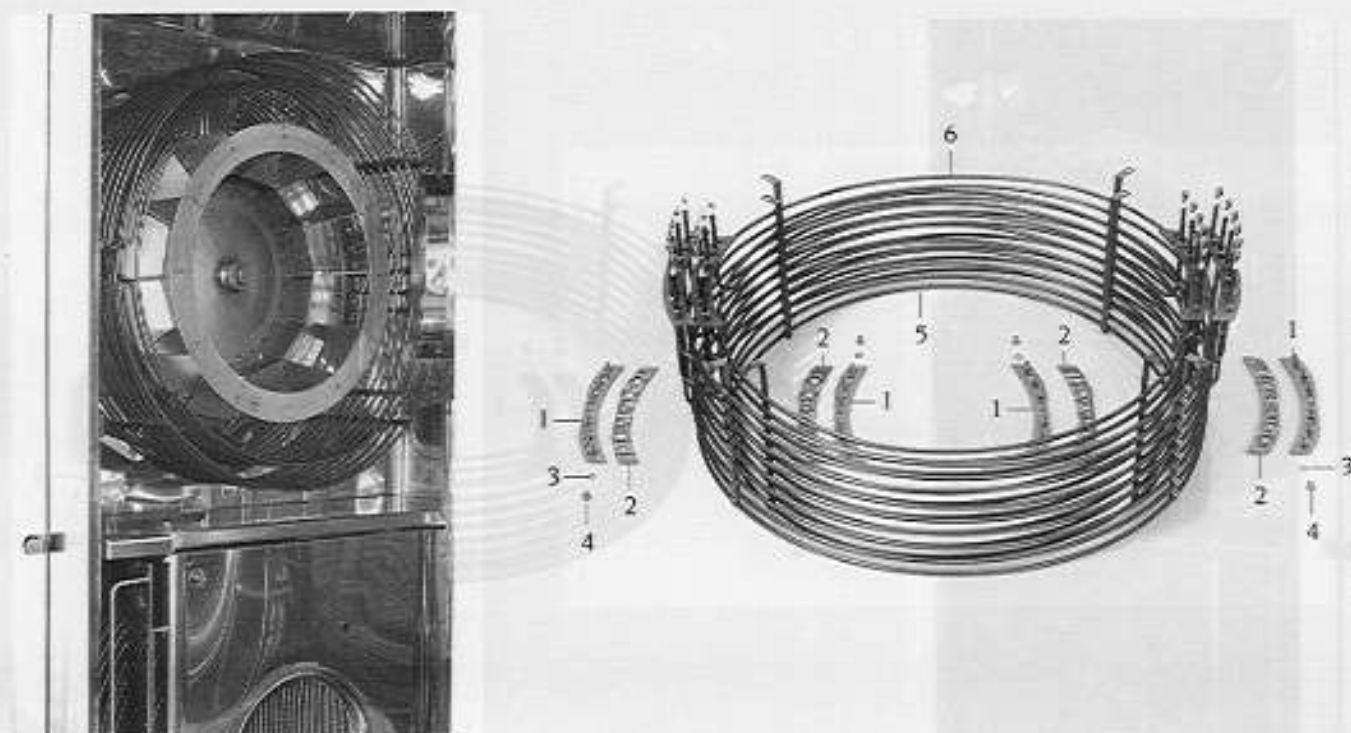

| Pos. | St. | Ersatz.Nr. | Bezeichnung | Description |
|------|------|--------------|------------------------------------|-------------------------------------|
| Pos. | Pcs. | Sp. Part No. | | |
| 1 | 8 | 2150.1005 | Flansch Außenseite f. Heizregister | External flange for heating element |
| 2 | 16 | 5110.1009 | Dichtring f. Heizregister | Seal ring for heating assembly |
| 3 | 64 | 1206.0261 | Federring B6 | Spring washer B6 |
| 4 | 64 | 1106.0360 | Hutmutter M6 | Cap nut M6 |
| 5 | 2 | 3200.1002 | Heizregister innen 230V | Inner heating assembly 230V |
| 6 | 2 | 3200.1003 | Heizregister außen 230V | Outer heating assembly 230V |

| | | | | |
|-----------------------------|---------------------|--------------------|--------------------|---|
| Garraum Interior Cabinet | Spannung Voltage | Baugruppe Group | Ausgabe Edition | gültig ab Seriennummer Application from Serial.No. |
| | 3 N AC 400V 50Hz | 7 | 7.1.1 | C22C93065001 |

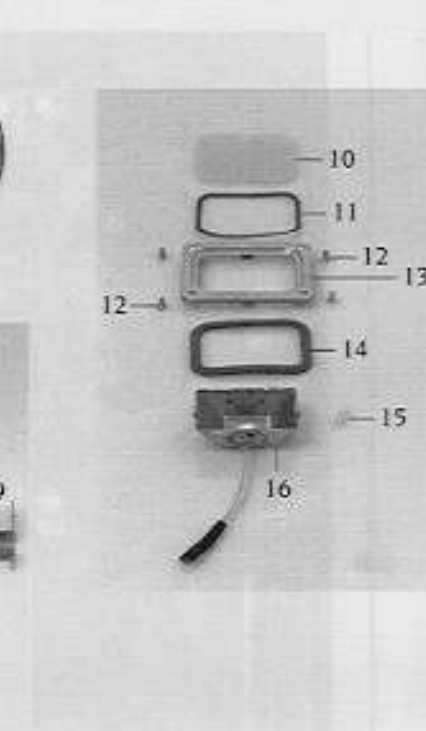
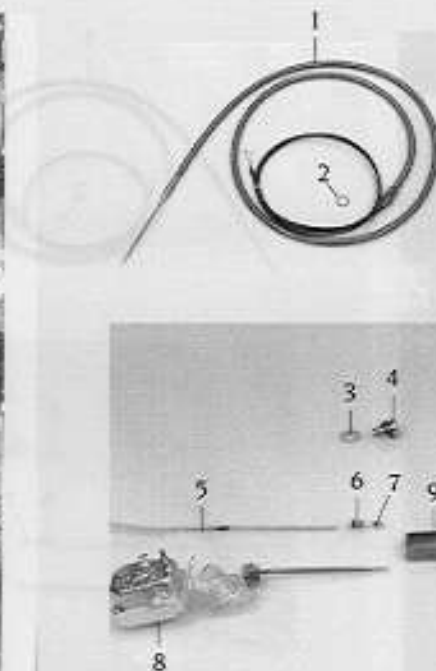
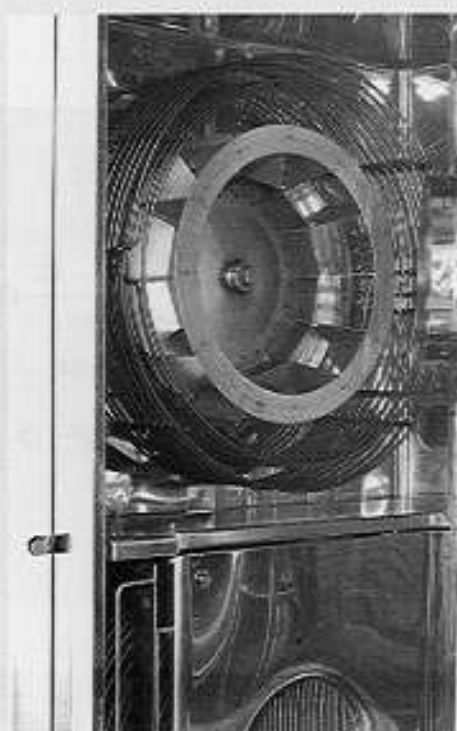

| Pos. | St. | Ersatz-Nr. | Bezeichnung | Description |
|------|------|--------------|---|--------------------------------------|
| Pos. | Pcs. | Sp. Part No. | | |
| - | 1 | 8516.1020 | Luftleitblech oben | Air baffle top |
| - | 1 | 8516.1021 | Luftleitblech unten | Air baffle bottom |
| - | 1 | 2005.0301 | Ablausieb | Outlet sieve |
| 1 | 1 | 3035.0702 | Einstechfühler | Meat probe sensor |
| 2 | 1 | 1315.0105 | Kupferdichtung für Einstechfühler | Copper gasket for meat probe sensor |
| 3 | 4 | 2043.0203 | Haltescheibe für Verschlußbolzen | Holder plate for air baffle |
| 4 | 4 | 2043.0201 | Verschlußbolzen für Luftleitblech | Locking pin for air baffle |
| 5 | 1 | 3014.0160 | Mantelthermoelement Garraum | Sheath thermo element |
| 6 | 1 | 3014.0163 | Stopfbuchsnippel für Thermoelement | Gasket sleeve with nipple |
| 7 | 1 | 3014.0162 | Dichtkegel für Thermoelement | Sealing cone for thermo element |
| 8 | 1 | 3014.0322 | Sicherheitstemperaturbegrenzer 360°C | Safety temperature limiter 360°C |
| 9 | 1 | 2720.1073 | Thermostathaltewinkel | Holding angle for thermostat |
| 10 | 2 | 5201.1000 | Glas f. Garraumbeleuchtung | Glass for interior lamp |
| 11 | 2 | 5110.1022 | Dichtungsrahmen außen f. Garraumbeleuchtung | External gasket frame |
| 12 | 8 | 1008.0753 | Sechskantschraube M5x8 | Hexagonal screw M5x8 |
| 13 | 2 | 8514.1017 | Andrückrahmen f. Garraumbeleuchtung | Press down frame |
| 14 | 2 | 5110.1023 | Dichtungsrahmen innen | Internal gasket frame |
| 15 | 2 | 3024.0201 | Halogengarraumlampe 10 W/12V/300°C | Halogen bulb 10 W/12V/300°C |
| 16 | 2 | 8514.1018 | Reflektor kpl. f. Garraumbeleuchtung | Reflector unit for interior lighting |

| | | | | |
|--|---------------------|--------------------|--------------------|---|
| Motor und Lüfterrad Motor and Fan Wheel | Spannung Voltage | Baugruppe Group | Ausgabe Edition | gültig ab Seriennummer Application from Serial.No. |
| | 3 N AC 400V 50Hz | 6 | 6.1.1 | C22C93065001 |

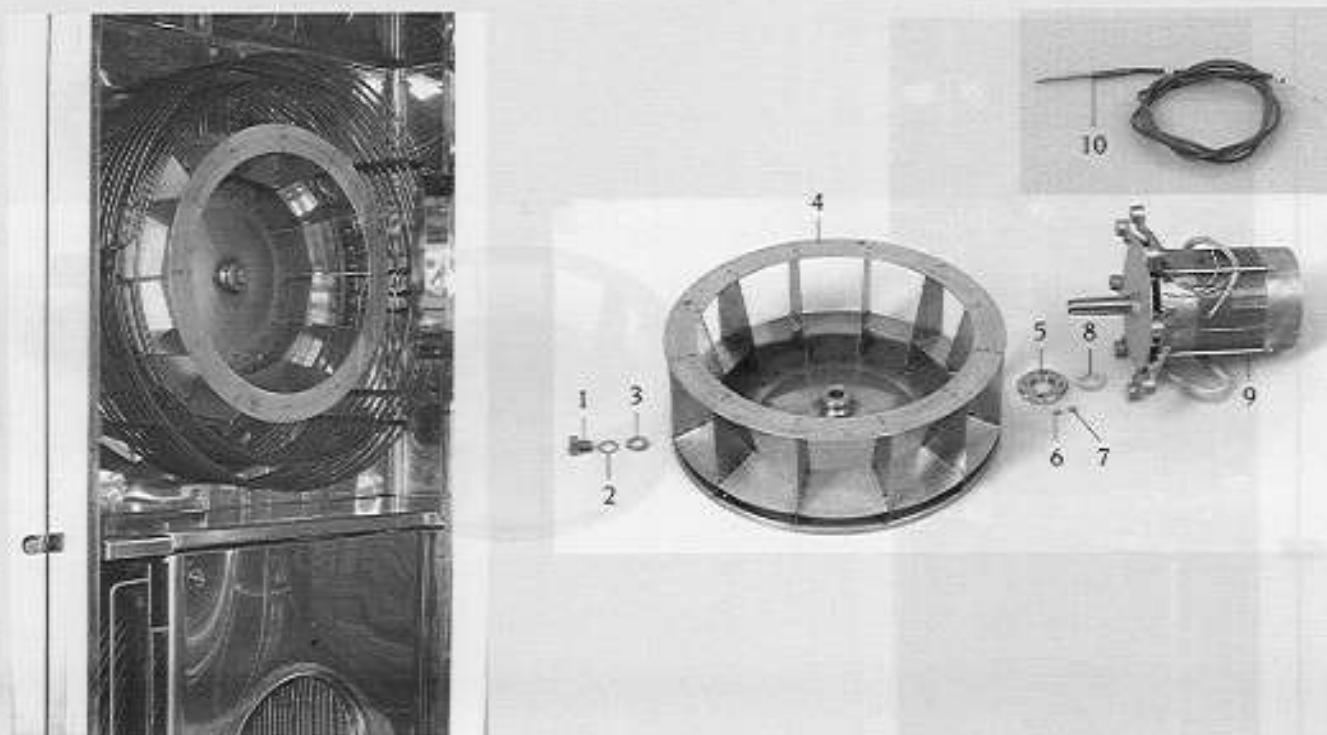

| Pos. | St. | Ersatz-Nr. | Bezeichnung | Description |
|------|------|--------------|---------------------------------|-------------------------------|
| Pos. | Pcs. | Sp. Part No. | | |
| 1 | 2 | 1016.0700 | Sechskantschraube M 16x20 | Hexagonal screw M16x20 |
| 2 | 2 | 1217.0160 | Zahnscheibe A 16,5 | Toothed disc A 16,5 |
| 3 | 2 | 1308.0123 | Unterlegscheibe A 17 | Washer A 17 |
| 4 | 2 | 2012.0901 | Lüfterrad | Fan wheel |
| 5 | 2 | 2016.0875 | Dichtungsflansch für Motorwelle | Gasket flange for motor shaft |
| 6 | 8 | 1315.0101 | Kupferdichtung 6x10 | Copper gasket 6x10 |
| 7 | 8 | 1106.0220 | Sechskantmutter M6 flach | Hexagonal nut M6 flat |
| 8 | 2 | 5001.0211 | Motorwellendichtung | Motor shaft gasket |
| 9 | 2 | 3100.1001 | Lüftermotor | Fan motor |
| - | 16 | 1206.0120 | Zahnscheibe d 6,4 | Toothed disc d 6,4 |
| - | 16 | 1106.0160 | Sechskantmutter M 6 | Hexagonal nut M6 |
| 10 | 1 | 3014.0161 | Mantelthermoelement | Sheath thermo element |
| - | 1 | 2066.0204 | Schlauchschelle 130-150mm | Hose clamp 130-150mm |

| | | | | |
|-----------------------------------|---------------------|--------------------|--------------------|---|
| Dampfgenerator Steam Generator | Spannung Voltage | Baugruppe Group | Ausgabe Edition | gültig ab Seriennummer Application from Serial.No. |
| | 3 N AC 400V 50Hz | 4 | 4.1.1 | C22C93065001 |

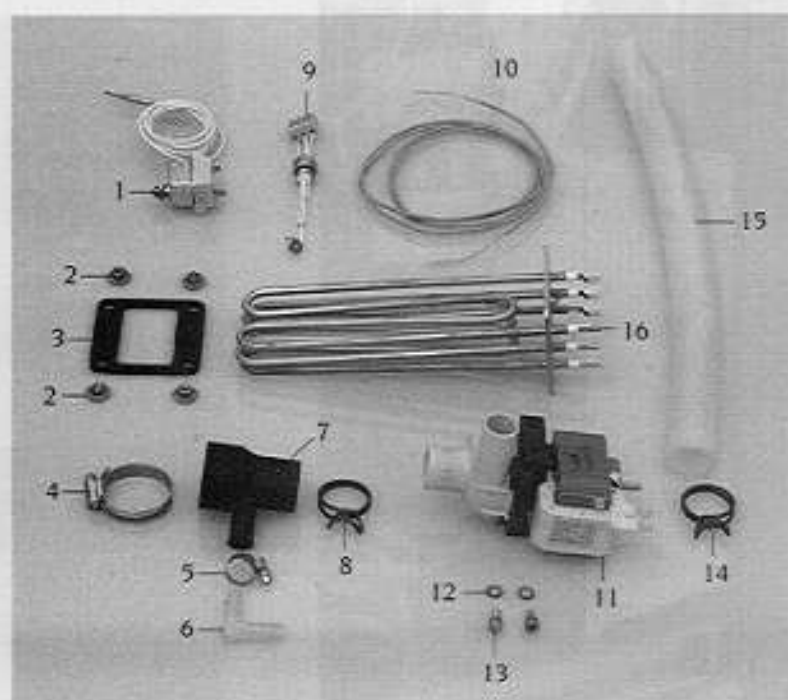
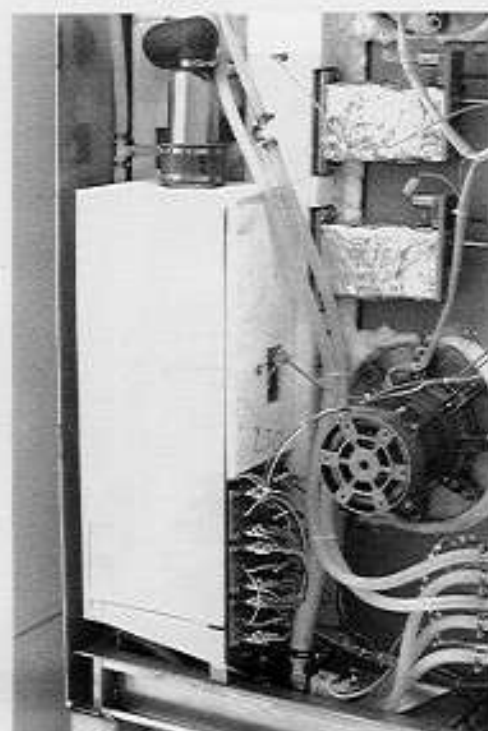

| Pos. | St. | Ersatz-Nr. | Bezeichnung | Description |
|------|------|--------------|-----------------------------------|------------------------------------|
| Pos. | Pcs. | Sp. Part No. | | |
| - | 1 | 8350.5005 | Dampfgenerator kpl. | Steam generator unit |
| 1 | 1 | 3014.0300 | Trockengeschütz 125 ° | Dry up protector 125 ° |
| - | 1 | 2740.1040 | Klemmblech Dampfgenerator | Clamping plate for steam generator |
| 2 | 24 | 1106.0801 | Sechskant-Combi-Mutter M 6 | Hexagonal combination nut M6 |
| 3 | 6 | 5110.1003 | Dichtung f. Tauchheizkörper | Gasket for heating element |
| 4 | 1 | 2066.0507 | Schlauchselle 32-50mm | Hose clamp 32-50mm |
| 5 | 2 | 2066.0205 | Schlauchselle 12-18mm | Hose clamp 12-18mm |
| 6 | 1 | 2062.0301 | Winkelstück Kunststoff WS 10 | Elbow piece plastic WS 10 |
| 7 | 1 | 2118.1000 | Pumpenanschlußstutzen | Pump connection spout |
| 8 | 1 | 2066.0519 | Schlauchklemme 35,6mm | Hose clamp 35,6mm |
| 9 | 1 | 3002.0402 | Füllstandselektrode 90mm. | Filling level electrode 90 mm |
| 10 | 1 | 3014.0165 | Thermoelement Dampfgenerator | Thermo element steam generator |
| 11 | 1 | 3002.1000 | Entleerungspumpe 200-240V 50/60Hz | Emptying pump 200-240V 50/60Hz |
| 12 | 2 | 1306.0120 | Unterlegscheibe A6,4 | Washer A6.4 |
| 13 | 2 | 1006.0621 | Innensechskantschraube M 6x12 | Allen screw M6x12 |
| 14 | 1 | 2066.0522 | Schlauchklemme 31,3mm | Hose clamp 31,3mm |
| 15 | 1 | 2112.1017 | Entleerschlauch 22x4x480 | Emptying hose 22x4x480 |
| 16 | 6 | 3201.1000 | Tauchheizkörper 3x3 kw/230V | Heating element 3x3 kw/230V |